

AUTOMATIC WATER SOFTENER GIX8

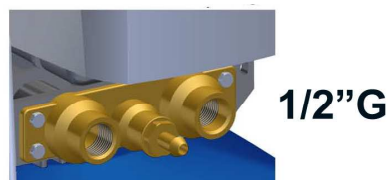

WATER NETWORK
CONNECTIONS



1/2" G

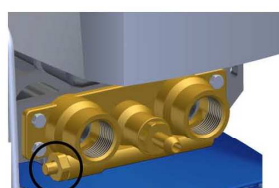

3/4" G

MIXER

TECHNICAL DATA

Weight	12 Kg
Power supply	standard 230V 50/60 Hz optional 120V 60 Hz
Maximum flow rate	1500 l/h
Room temperature	4°C - 30°C
Power requirement	4 W
Regeneration salt amount	1.0 kg
Maximum salt content in the brine tank	20 Kg

SUPPLY WATER CHARACTERISTICS

Drinking water	
Crystal-clear water (SDI 1)	
Temperature	4°C - 25°C
Pressure	2 bar - 8 bar
Maximum hardness	90 °f

1 WATER SOFTENER CONSISTING OF:

- 1 brine tank
- 1 Autotrol 255/740 Logix valve
- 1 cylinder of 8 litres holding 5.5 litres of cationic resins adapt for softening
- 1 instruction manual
- 3 m of unloading pipe
- 1 overflow curved union joint
- 1 fitting for the unloading pipe
- 1 chlorine generator (OPTIONAL)

PRODUCT CODE:

- AAX02 with connections 1/2" G
- AAX05 with connections 3/4" G mixer

THE WATER SOFTENER IS SUITED FOR:



LITRES OF SOFTENED WATER ACCORDING TO ITS HARDNESS

°f	20	30	40	50	60	CYCLIC CAPACITY [m ³ ·°f]
°d	11	16	22	28	33	
ppm CaCO ₃	200	300	400	500	600	
	1680	1120	840	672	560	33.6